

MODEL:

PDUMVR30HVNETLX

Single-Phase Switched Rack-mount PDU



High Voltage
Input/Output



24 Outlets



5/5.8kW Load
Capacity



L6-30P Plug



Multimode
Load Meter

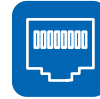

Network
Interface



0U Rack-mount



Toolless
Mounting
Buttons

- A** Digital Load Meter
- B** C13 and C19 Outlets with On/Off LEDs
- C** 20A Circuit Breakers
- D** Removable Cord Retention Brackets
- E** Removable Mounting Brackets
- F** Toolless Mounting Buttons with Removable 90° Rotation Brackets
- G** 10 ft. Input Power Cord
- H** L6-30P Twist-Lock Input Plug
- I** Durable Metal Case
- J** WEBCARDLX Interface
- K** RJ45 Ethernet Jack
- L** Manual Configuration Port
- M** USB Port
- N** WEBCARDLX Interface Reset Button
- O** Status LED

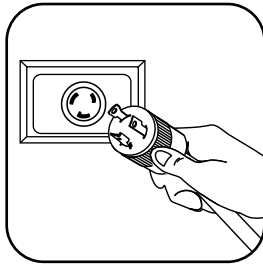

AC Input Connection: Insert L6-30P twist-lock plug into compatible L6-30R utility, generator or UPS outlet.

Also Includes: Owner's manual, configuration cable and cable ties.

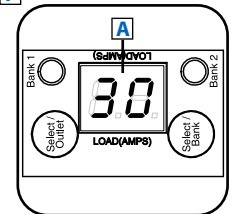
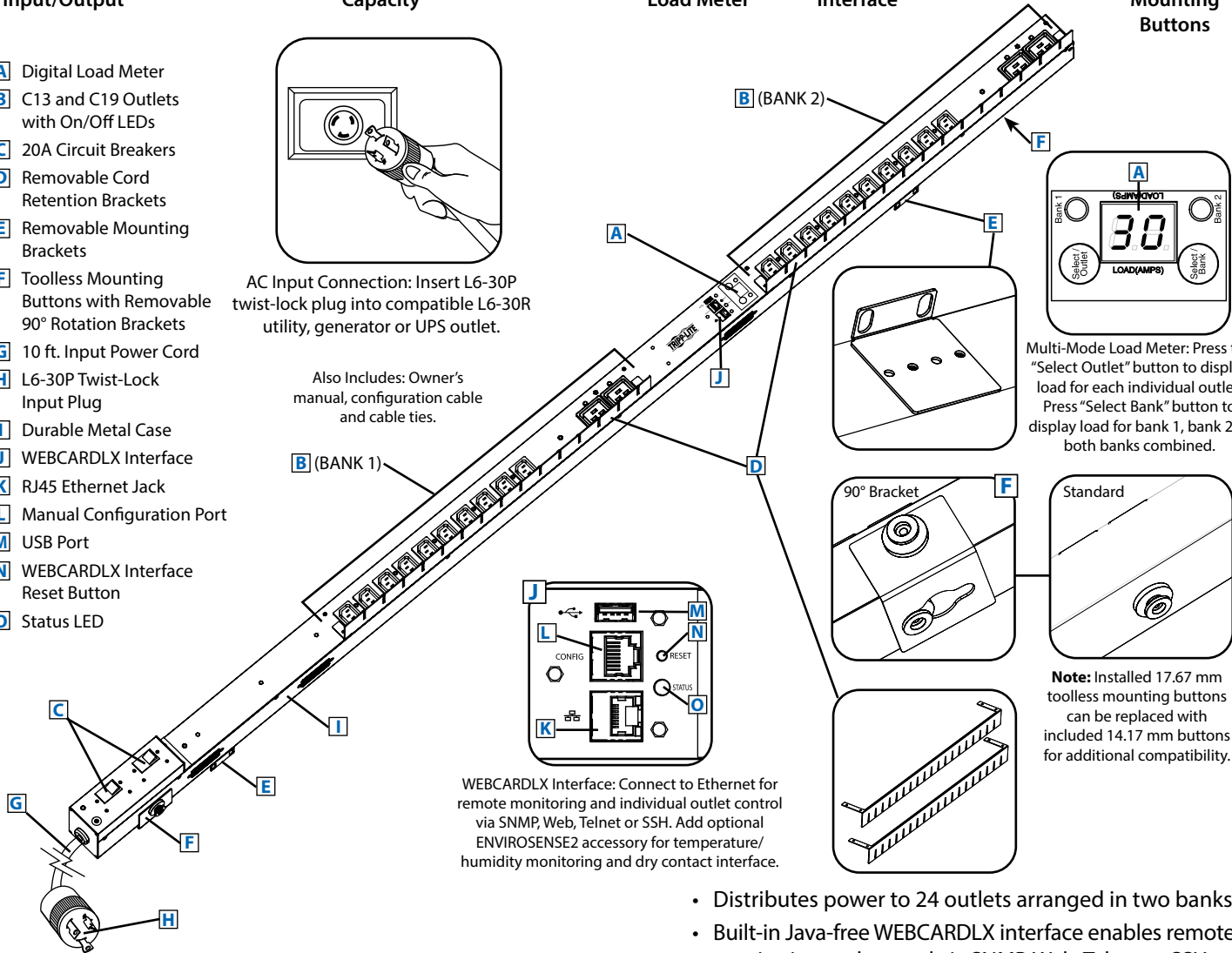

Multi-Mode Load Meter: Press the "Select Outlet" button to display load for each individual outlet. Press "Select Bank" button to display load for bank 1, bank 2 or both banks combined.

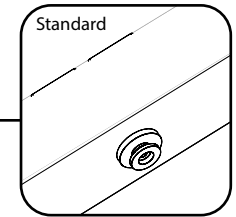
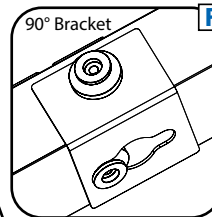
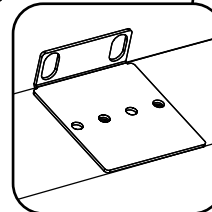

Note: Installed 17.67 mm toolless mounting buttons can be replaced with included 14.17 mm buttons for additional compatibility.

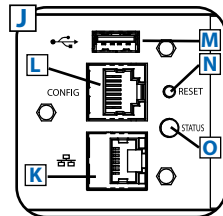

WEBCARDLX Interface: Connect to Ethernet for remote monitoring and individual outlet control via SNMP, Web, Telnet or SSH. Add optional ENVIROSENSE2 accessory for temperature/humidity monitoring and dry contact interface.

- Distributes power to 24 outlets arranged in two banks
- Built-in Java-free WEBCARDLX interface enables remote monitoring and control via SNMP, Web, Telnet or SSH
- Displays load for each individual outlet, load bank or both load banks combined in real time
- Perfect for rack-mount server, network and telecom applications

SEE NEXT PAGE FOR DETAILED UNIT MEASUREMENTS



1111 W. 35th Street
Chicago, IL 60609 USA
773.869.1234
www.tripplite.com

Specifications

Model	PDUMVR30HVNETLX
Voltage	208/240V
Frequency	50/60 Hz
Load Capacity	5.8kW (240V), 5kW (208V)
Input Connector	L6-30P
Cord Length	10 ft.
Outlets	24 (20 C13 / 4 C19)
Primary Mounting Option	0U (Vertical) Rack-mount
Unit Weight & Dimensions	10.4 lb / 70 x 2.20 x 1.89 (HWD in inches) 4.7 kg / 1778 x 55.9 x 48 (HWD in mm)
Standards	Tested to UL 60950-1 (US & Canada), NOM (Mexico), FCC Class A and RoHS standards



