



MODEL:

PDU3EVS6L2130

3-Phase Switched Rack-Mount PDU

- 

**208/240V
3-Phase Input**
- 

**NEMA L21-30P
Plug**
- 

**208/240V
Single-Phase
Output**
- 

**30 Switched
Outlets**
- 

**10kW Load
Capacity**
- 

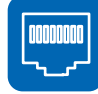
**Touchscreen
LCD**
- 

**Network
Interface**
- 

**0U
Rack-Mount**
- 

**Toolless
Mounting
Buttons**

- A** Color Touchscreen LCD
- B** C13 and C19 Outlets with Multi-Function LEDs
- C** C13 and C19 Plug Inserts
- D** Removable Mounting Brackets
- E** Toolless Mounting Buttons with Removable 90° Rotation Brackets
- F** 6 ft. Input Power Cord
- G** NEMA L21-30P Input Plug
- H** Durable Metal Case
- I** LX Platform Interface
- J** USB-B Port (for Direct Console Access)
- K** USB-A Ports (for EnviroSense2 Sensors)
- L** RJ45 Configuration Port
- M** Ethernet Port
- N** Network Interface Reset Button

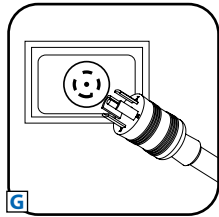

AC Input Connection: Insert NEMA L21-30P plug into compatible utility, generator or UPS outlet.

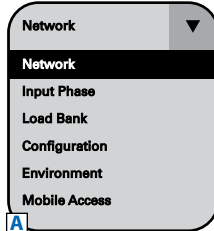

Color Touchscreen LCD: Easily toggle between menus to monitor input current level per phase, output current per load bank, environmental sensor data and network information. It also generates a unique QR code to allow access to the monitored PDU through a mobile device.

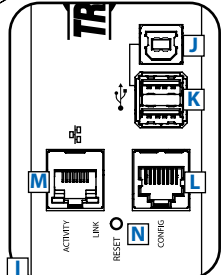
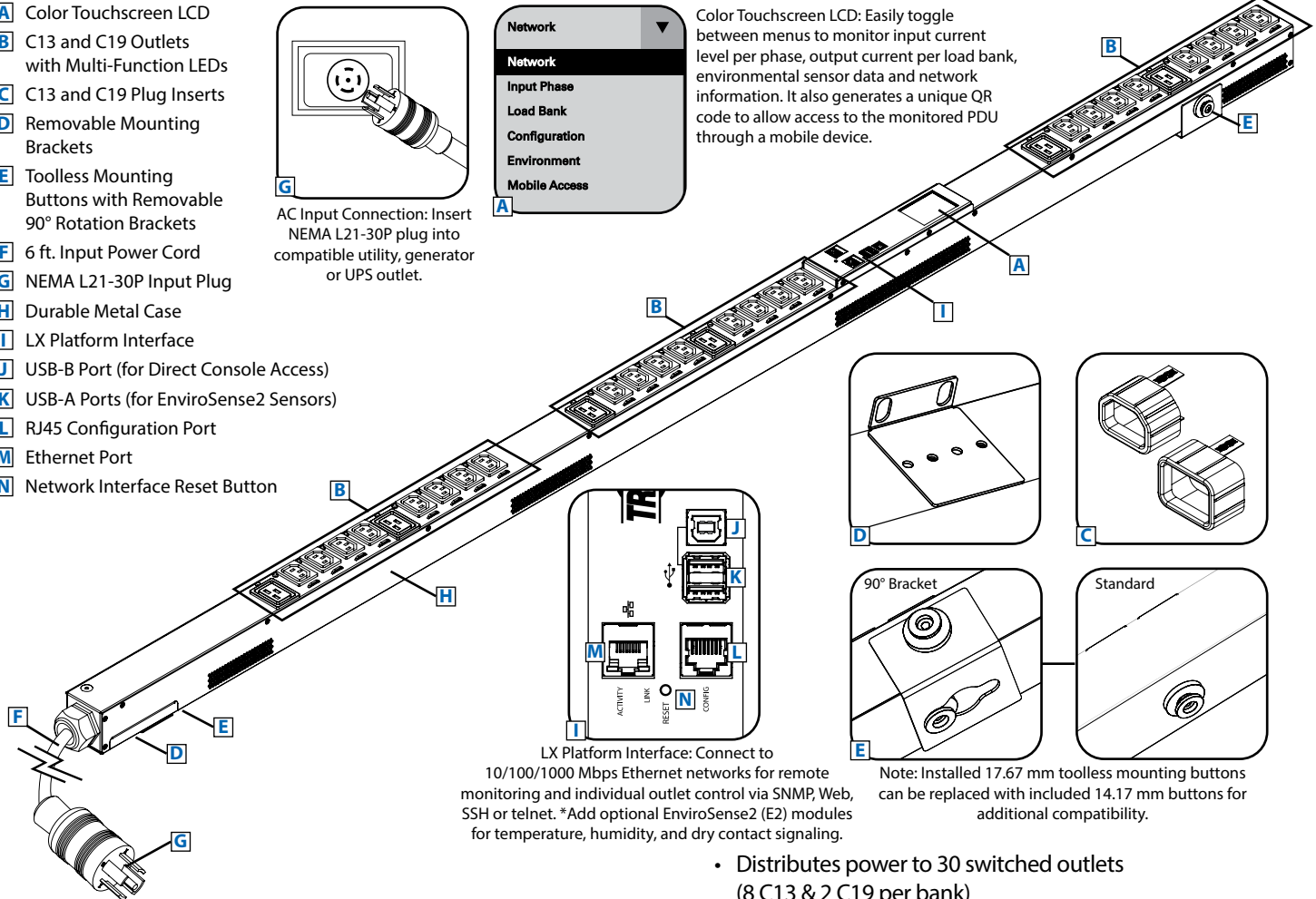

LX Platform Interface: Connect to 10/100/1000 Mbps Ethernet networks for remote monitoring and individual outlet control via SNMP, Web, SSH or telnet. *Add optional EnviroSense2 (E2) modules for temperature, humidity, and dry contact signaling.

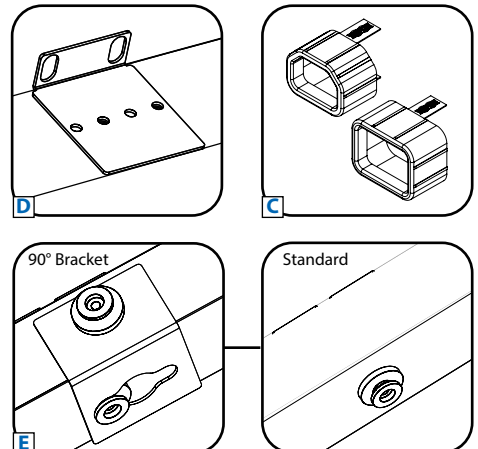

Note: Installed 17.67 mm toolless mounting buttons can be replaced with included 14.17 mm buttons for additional compatibility.

Specifications

Model	PDU3EVS6L2130
Voltage	208/240V (3-Phase Input/Single-Phase Output)
Frequency	50/60 Hz
Load Capacity	10kW (240V), 9.6kW (230V), 9.1kW (220V), 8.6kW (208V)
Input Plug	NEMA L21-30P
Input Cord Length	6 ft. / 1.83 m
Outlets	30 (24 C13 / 6 C19)
Primary Mounting Option	0U (Vertical) Rack-Mount
Unit Dimensions	70 x 2.17 x 2.45 in. / 1778 x 55 x 63 mm
Unit Weight	16.8 lb. / 7.6 kg
Standards	Tested to UL/CSA 60950-1 (US & Canada), NOM (Mexico), FCC Class A, RoHS, TAA Compliant



- Distributes power to 30 switched outlets (8 C13 & 2 C19 per bank)
- Java-free, HTML5-based network interface allows for remote monitoring and control via SNMP, Web, SSH or telnet
- Displays load for each bank and phase, and total output in real time with $\pm 1\%$ billing grade accuracy
- Perfect for rack-mount server, network and telecom applications

SEE NEXT PAGE FOR DETAILED UNIT MEASUREMENTS



1111 W. 35th Street
Chicago, IL 60609 USA
773.869.1234
www.tripplite.com

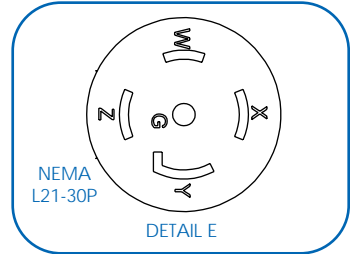
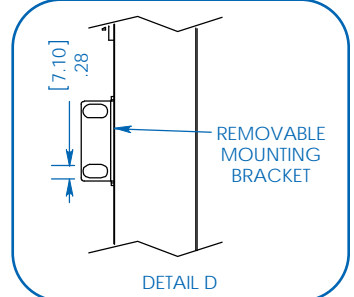
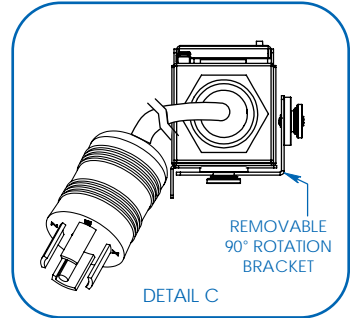
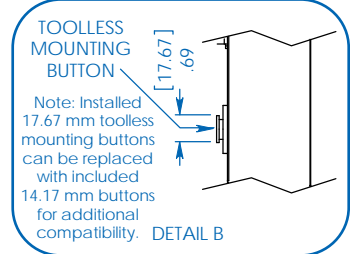
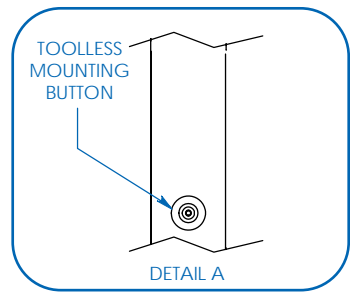
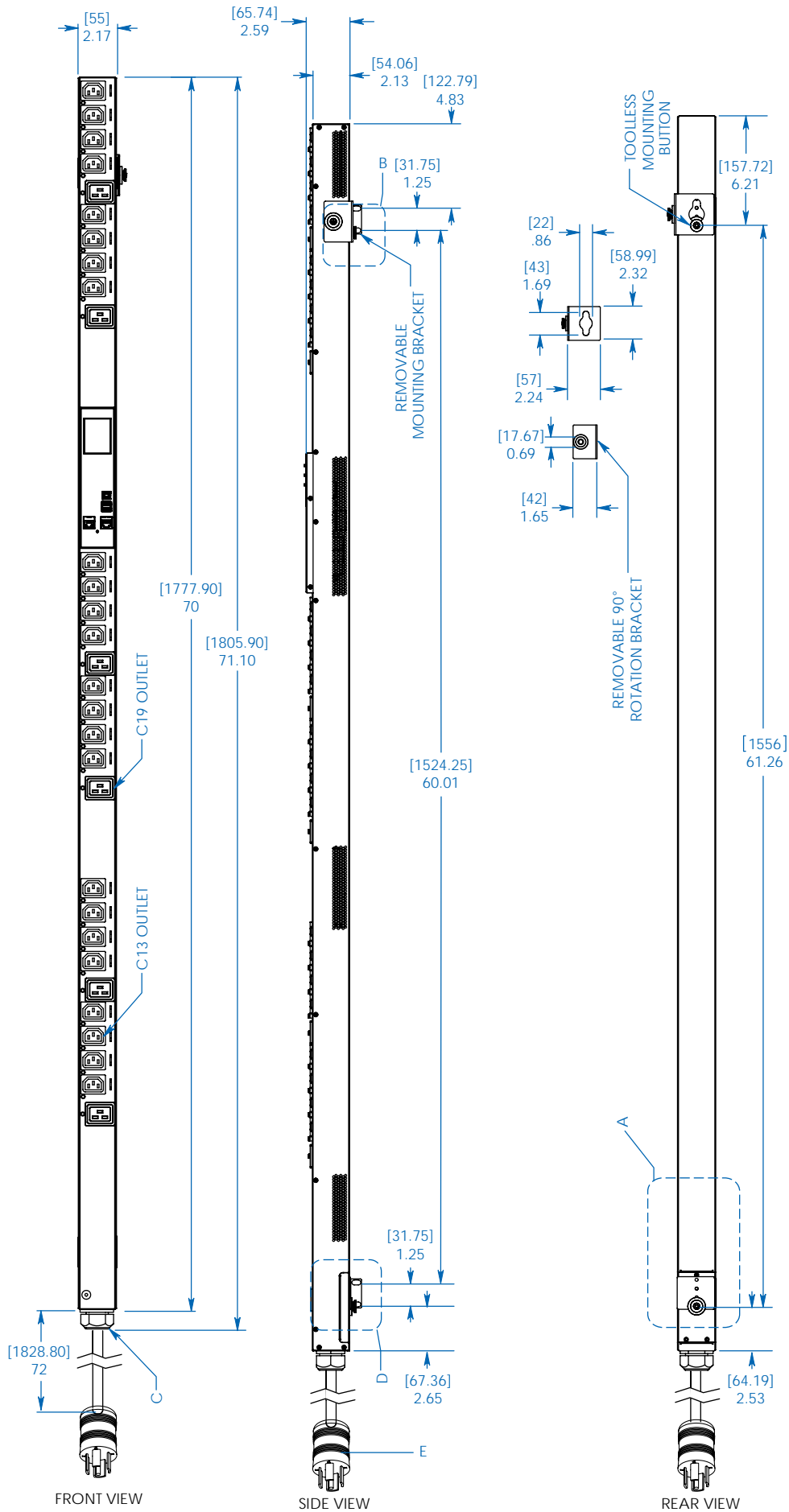

Dimensions: [mm] INCHES

Tripp Lite has a policy of continuous improvement. Specifications are subject to change without notice. Photos and illustrations may differ slightly from actual products.

MODEL:
PDU3EVS6L2130



1111 W. 35th Street
Chicago, IL 60609 USA
773.869.1234

www.tripplite.com