

REV	DATE	ECO-CODE	MODIFICATION	PREPARED	APPROVED
00	05-Jan-2026		FIRST ISSUE	Xinwei Yang	Xin Su

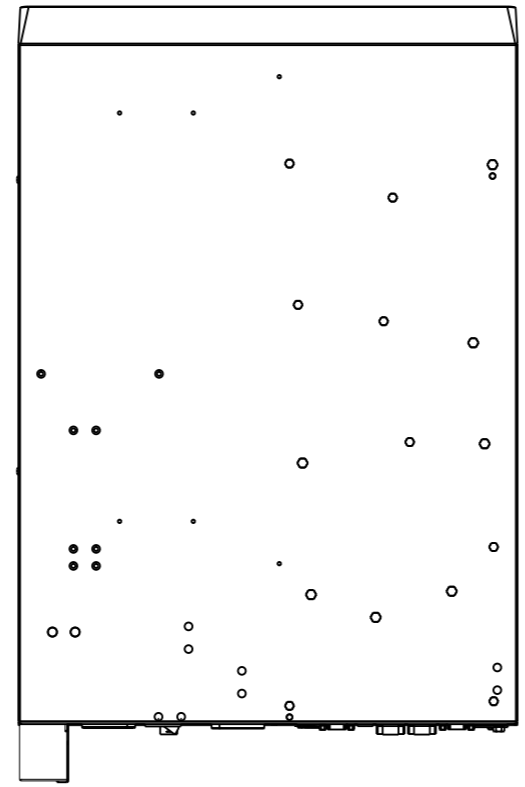
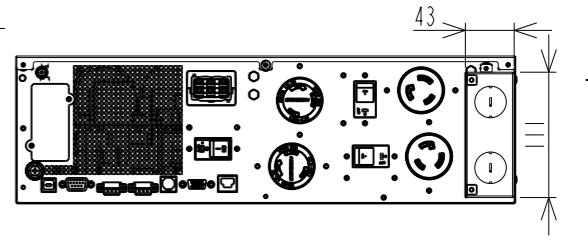
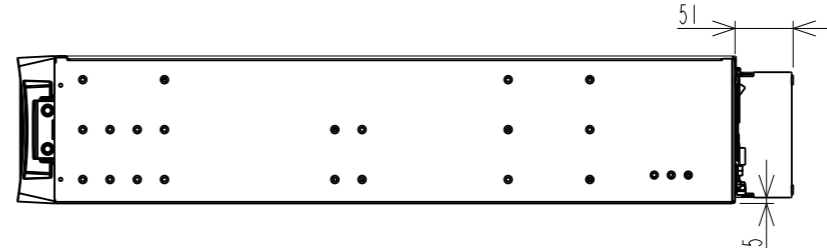
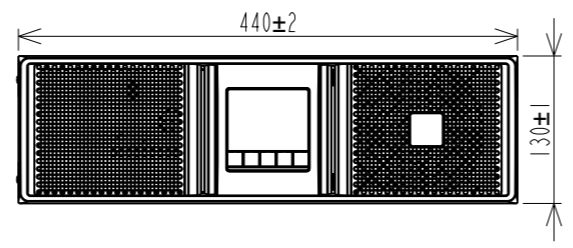
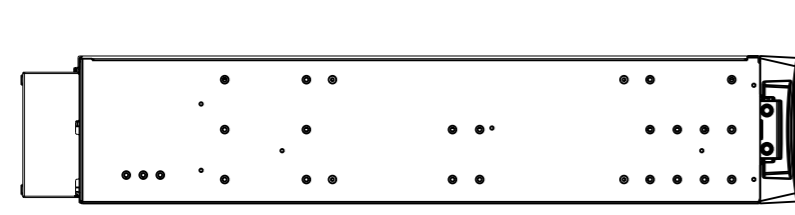
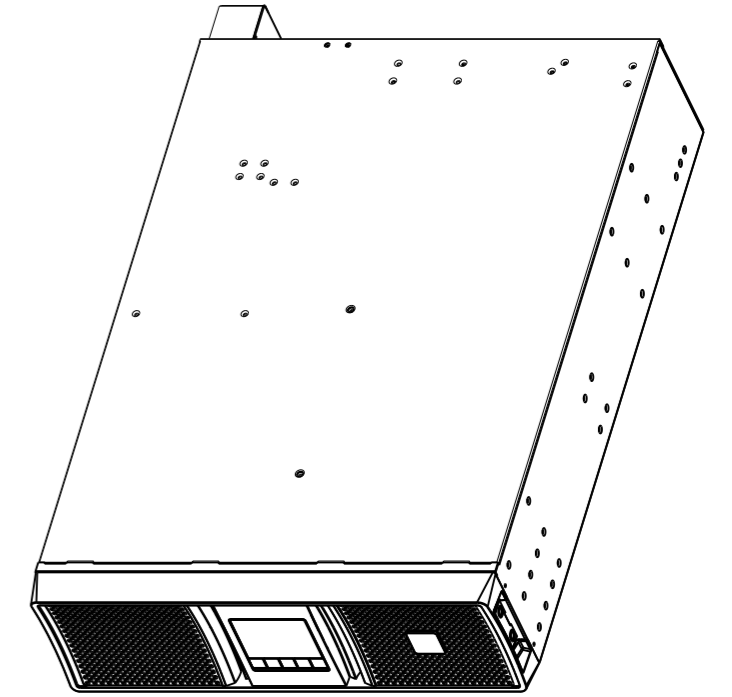
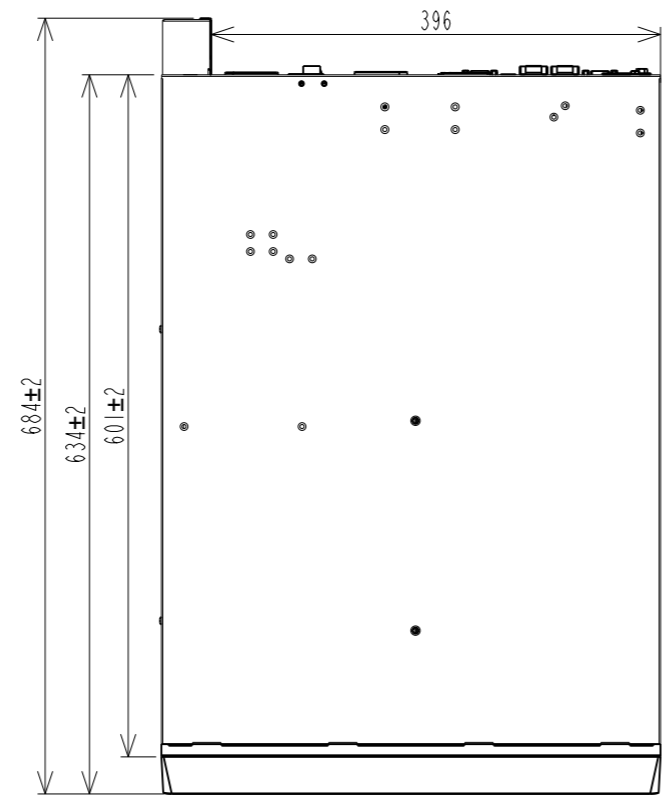

METRIC		EATON CORPORATION			
DIMENSIONS ARE IN MILLIMETERS AFTER PLATING. DIMENSIONS AND TOLERANCES IN ACCORDANCE WITH ASME Y14.5M-1994. SEE NOTES FOR TOLERANCES.					
DESCRIPTION: Eaton 9PX Li-Ion 6000 RT3U G2					
ORIGINATED: Xinwei Yang	05-Jan-2026	ECO:	NAME:	REVISION:	SIZE: A3
MODIFIED: /	05-Jan-2026		9PX6KG2-L	00	SCALE:
CHECKED: /	05-Jan-2026	DOCUMENT TYPE:		STATE:	0.150
SAFETY: /	05-Jan-2026	PRO-E DRAWING		Released	SHEET:
APPROVED: Xin Su	05-Jan-2026				1 OF 2

EATON CORPORATION - CONFIDENTIAL AND PROPRIETARY
 NOTICE TO PERSONS RECEIVING THIS DOCUMENT AND/OR TECHNICAL INFORMATION
 THIS DOCUMENT, INCLUDING THE DRAWING AND INFORMATION CONTAINED THEREON, IS CONFIDENTIAL AND IS THE EXCLUSIVE PROPERTY OF EATON CORPORATION, AND IS MERELY ON LOAN AND SUBJECT TO RECALL BY EATON AT ANY TIME. BY TAKING POSSESSION OF THIS DOCUMENT, THE RECIPIENT ACKNOWLEDGES AND AGREES THAT THIS DOCUMENT CANNOT BE USED IN ANY MANNER ADVERSE TO THE INTERESTS OF EATON AND THAT NO PORTION OF THIS DOCUMENT MAY BE COPIED OR OTHERWISE REPRODUCED WITHOUT THE PRIOR WRITTEN CONSENT OF EATON. IN THE CASE OF CONFLICTING CONTRACTUAL PROVISIONS, THIS NOTICE SHALL GOVERN THE STATUS OF THIS DOCUMENT. © 2011 Eaton Corporation - All Rights Reserved.

NOTES:
 RCD: (xxx+/- .xxx) STD: .xxx+/- .xxx (ST) Key Dimension: *
 1 RCD: Required Control Dimension ,These Dimensions need Process control & capability(initial and ongoing), 100%inspection, poke yoke, etc.as appropriate.
 2 STD: Statistically Toleranced Dimension ,These Dimensions need demonstration of ongoing process capability (CpK/PpK).
 3 Key Dimension:These Dimensions are defined by ME/Mfg,and need inspection as appropriate. If you want more information,please review the criterions of <TC-RDW-18>and<TC-QAW-40>

REV.	DATE	ECO-CODE	Modification	Prepared	Approved

9PX6KG2-L

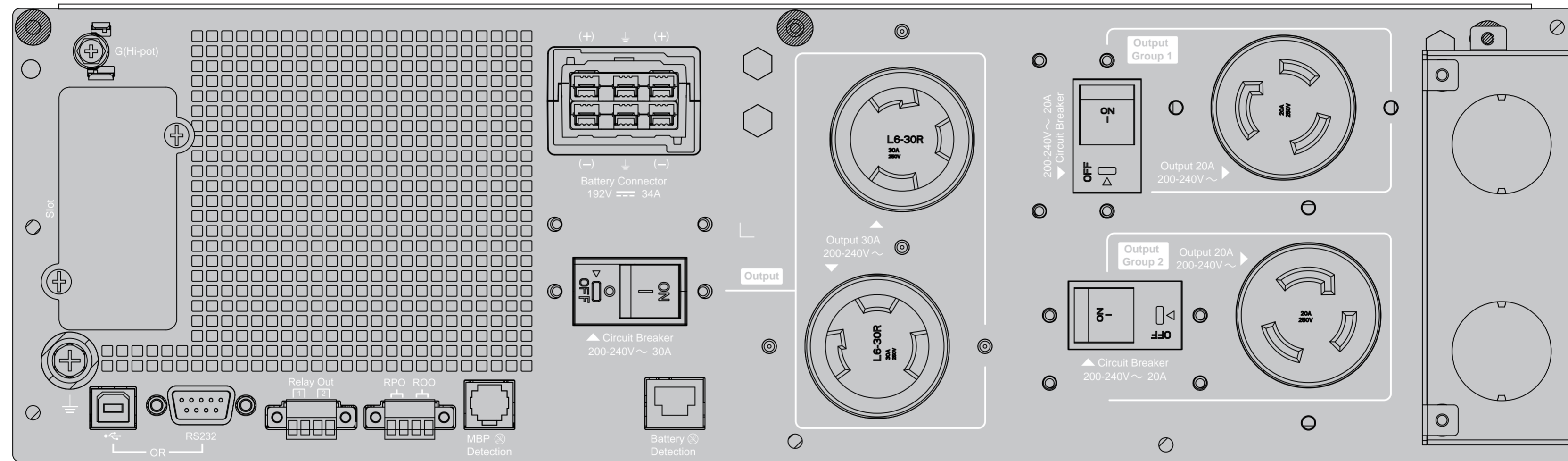

METRIC	THIRD ANGLE PROJECTION	EATON CORPORATION		EATON	
DIMENSIONS ARE IN MILLIMETERS AFTER PLATING. DIMENSIONS AND TOLERANCES IN ACCORDANCE WITH ASME Y14.5M-1994. SEE NOTES FOR TOLERANCES.					
DESCRIPTION: Eaton 9PX Li-Ion 6000 RT3U G2					
ORIGINATED: Xinwei Yang	05-Jan-2026	ECO:	NAME:	REVISION: 00	SIZE: A2
MODIFIED: /	05-Jan-2026			STATE: Released	SCALE: 1:1
CHECKED: /	05-Jan-2026	DOCUMENT TYPE:	9104-LB12012		SHEET: 2 OF 2
SAFETY: /	05-Jan-2026	PRO-E DRAWING			
APPROVED: Xin Su	05-Jan-2026				

EATON CORPORATION - CONFIDENTIAL AND PROPRIETARY
 NOTICE TO PERSONS RECEIVING THIS DOCUMENT AND/OR TECHNICAL INFORMATION
 THIS DOCUMENT, INCLUDING THE DRAWING AND INFORMATION CONTAINED THEREON, IS CONFIDENTIAL AND IS THE EXCLUSIVE PROPERTY OF EATON CORPORATION, AND IS MERELY ON LOAN AND SUBJECT TO RECALL BY EATON AT ANY TIME. BY TAKING POSSESSION OF THIS DOCUMENT, THE RECIPIENT ACKNOWLEDGES AND AGREES THAT THIS DOCUMENT CANNOT BE USED IN ANY MANNER ADVERSE TO THE INTERESTS OF EATON AND THAT NO PORTION OF THIS DOCUMENT MAY BE COPIED OR OTHERWISE REPRODUCED WITHOUT THE PRIOR WRITTEN CONSENT OF EATON. IN THE CASE OF CONFLICTING CONTRACTUAL PROVISIONS, THIS NOTICE SHALL GOVERN THE STATUS OF THIS DOCUMENT.