

# 1.9kW Single-Phase Monitored Per-Outlet PDU - LX Platform, 24 5-15/20R Outlets (120V), L5-20P/5-20P Input, 0U, TAA

MODEL NUMBER: PDUNVR20LX

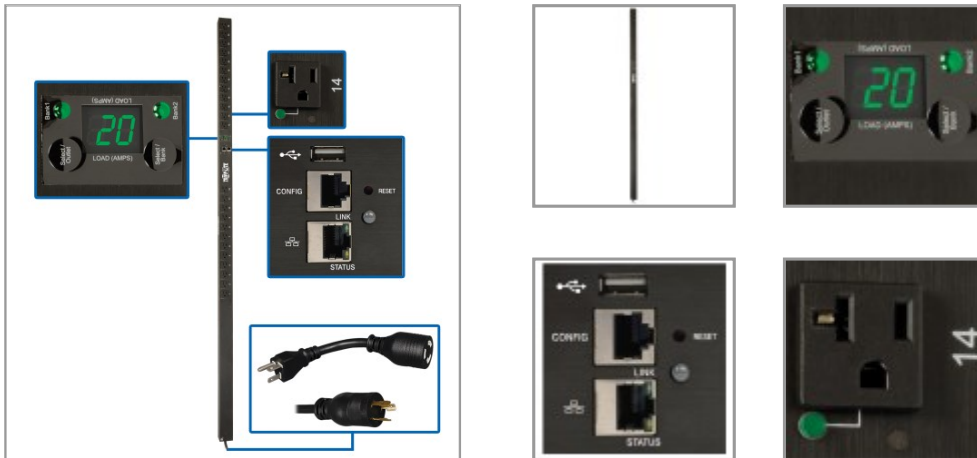

Allows real-time remote monitoring of individual outlets to ensure proper load balance and detect problems that could cause costly downtime.

## Features

**1.9kW Single-Phase PDU Distributes and Monitors Network-Grade Power** This monitored PDU provides real-time remote monitoring of voltage and load levels via its built-in network interface. Ideal for your small-to-mid-sized data center, computer room or high-density network closet, the PDUNVR20LX features 24 NEMA 5-15/20R 120V outlets, which distribute AC power to rack equipment. Advanced network power monitoring provides 1% billing-grade power consumption data for devices connected to each outlet.

**Monitored Per-Outlet PDU Lets You Keep Track of Power Consumption in Real Time** Not only can you remotely monitor voltage and frequency, but the PDUNVR20LX also allows metering of input current, as well as output current per outlet. Outlets can be individually monitored to ensure proper load balance and prevent downtime. Monitoring each outlet allows you to study power consumption trends for each connected device. This helps you detect hardware problems and network traffic bottlenecks, as well as compare power usage among various devices.

**Built-In LX Platform Network Management Card Allows Remote Access 24/7** The built-in WEBCARDLX with the latest version of PowerAlert Device Manager firmware (PADM20) provides enhanced remote management capabilities, including customizable dashboard graphs to fit user preferences. The PADM20 upgrade and Tripp Lite's PowerAlert Element Manager (PAEM) software form a powerful tool for expanding maintenance functions in large installations, including firmware update checks and backup and restoration of device configurations.

**Auto Probe Allows Autonomous PDU Management** The LX Platform interface allows use of Tripp Lite's IP-based Auto Probe feature, which ensures continuous network uptime by communicating with other network devices. If communication is lost, Auto Probe autonomously performs one or more user-configurable actions that help you return the network devices to an operational state, including email notifications. The innovative Auto Probe is especially ideal for ATMs, retail kiosks, digital signage, edge computing and PC gaming centers.

**Digital Load Meter Helps Prevent Potentially Expensive Overloads** A digital ammeter reports the load for each outlet separately and the total connected load. Monitoring amperage helps ensure load levels remain well below maximum capacity with no danger of overload that could lead to costly downtime or

## Highlights

- Advanced remote capabilities include outlet-level current monitoring in real time
- 24 NEMA 5-15/20R 120V outlets distribute AC power to connected equipment
- Pre-installed WEBCARDLX with latest version of PADM20 for enhanced remote management
- IP-based Auto Probe detects lost connectivity and notifies you immediately via email
- Digital ammeter for on-site load monitoring helps prevent power overloads

## Applications

- Power mission-critical rack equipment in a small-to-mid-sized data center, computer room or high-density network closet in a government, commercial or industrial facility
- Monitor power loads from various computers, switches, servers and other networking equipment
- Study power consumption trends over time for equipment connected to each individual outlet

## Package Includes

- PDUNVR20LX 1.9kW Single-Phase Monitored Per-Outlet PDU
- Built-in LX Platform interface
- Configuration cable
- (2) Cable retention brackets
- (24) Cable ties
- Rack-mounting hardware
- PDUMVROTATEBRKT mounting bracket accessory
- NEMA 5-20P plug adapter
- Owner's manual



damaged equipment.

**Easy to Install Vertically in an EIA-Standard 19 in. Rack**The 70-inch 0U PDU mounts vertically using the included toolless mounting buttons or the included rack-mounting brackets. Spare buttons are also included. Use the included PDUMVROTATEBRKT kit to install the PDU with outlets facing the rear for better airflow or equipment access. A 10-ft. (3.05 m) cord with a NEMA L5-20P input and optional 5-20P adapter connects the PDU to a compatible AC power source, such as a generator or protected UPS.

**TAA-Compliant for GSA Schedule Purchases**The PDUNVR20LX is compliant with the Federal Trade Agreements Act (TAA), which makes it eligible for GSA (General Services Administration) Schedule and other federal procurement contracts.

## Specifications

| OVERVIEW                          |  |
|-----------------------------------|--|
| UPC Code                          | 037332242266   |
| PDU Type                          | Monitored  |
| INPUT                             |  |
| PDU Input Voltage                 | 120  |
| Recommended Electrical Service    | Single-phase 20A 120V service  |
| Maximum Input Amps                | 16   |
| Maximum Input Amps Details        | Agency de-rated to 16A continuous  |
| PDU Plug Type                     | NEMA 5-20P; NEMA L5-20P  |
| Input Phase                       | Single-Phase   |
| Input Cord Length (ft.)           | 10   |
| Input Cord Length (m)             | 3.05   |
| OUTPUT                            |  |
| Output Capacity Details           | 1.92kW (120V) / 16A total capacity; 16A max per outlet   |
| Frequency Compatibility           | 50 / 60 Hz   |
| Output Receptacles                | (24) 5-15/20R  |
| Output Nominal Voltage            | 120V   |
| USER INTERFACE, ALERTS & CONTROLS |  |
| Front Panel LCD Display           | Digital display reports load level in amps for LOAD BANK 1 (Outlets 1-12), LOAD BANK 2 (Outlets 13-24), LOAD BANKS 1&2 COMBINED (Outlets 1-24) and each individual output receptacle; Digital display can also be used to scroll the configured IP address   |
| Front Panel LEDs                  | BANK 1 and BANK 2 LEDs verify the load bank the digital current display is reporting (Bank 1, Bank 2 or Banks 1&2 Combined); BANK 1 or BANK 2 LED will flash when the digital display is reporting output current for one of the outlets in that load bank; 24 additional LEDs, one near each output receptacle, will light continuously to verify power on status and flash to indicate that the digital display is reporting output current for just that individual receptacle. LX Platform Interface: Network Link/Activity Status LED (Yellow), Network Speed LED (Green); LX Platform status LED (Green) |



|                                      |  |
|--------------------------------------|--|
| Switches                             | SELECT OUTLET and SELECT BANK switches advance the LCD screen and associated LED to display power consumption for individual output receptacles and output load banks; Press and hold the SELECT BANK button for 4 seconds to rotate the digital display 90 degrees for overhead power input; Press and hold the SELECT OUTLET button for 4 seconds to scroll the configured IP address. LX Platform Interface: Recessed reset switch for interface reboot and factory reset |
| Current Measurement Accuracy (Amps)  | +/-1%  |
| Voltage Measurement Accuracy (Volts) | +/-1%  |
| Power Measurement Accuracy (Watts)   | +/-1%  |
| <b>SURGE / NOISE SUPPRESSION</b>     |  |
| Automatic Shut-Off                   | No   |
| <b>PHYSICAL</b>                      |  |
| Material of Construction             | Metal  |
| Form Factors Supported               | 0U vertical rackmount; includes rackmount brackets. Supports toolless mounting in button-mount compatible racks  |
| PDU Form Factor                      | Vertical (0U)  |
| Shipping Dimensions (hwd / in.)      | 4.53 x 6.10 x 75.78  |
| Shipping Weight (kg)                 | 6.77   |
| Unit Dimensions (hwd / in.)          | 70 x 2.2 x 2.04  |
| Unit Dimensions (hwd / cm)           | 178 x 5.6 x 5.2  |
| Unit Weight (lbs.)                   | 9.6  |
| Unit Weight (kg)                     | 4.35   |
| <b>ENVIRONMENTAL</b>                 |  |
| Operating Temperature Range          | 0C ~ 40C (32F ~ 104F)  |
| Storage Temperature Range            | -15°C to +60°C (5°F to +140°F)   |
| Relative Humidity                    | 5-95% non condensing   |
| Operating Elevation (ft.)            | 0-10,000   |
| Operating Elevation (m)              | 0-3000   |
| <b>COMMUNICATIONS</b>                |  |
| PowerAlert Software                  | LX Platform Interface: PowerAlert Device Manager   |
| Communications Cable                 | RJ45-to-DB9 configuration/console Access cable   |
| Network Monitoring Port              | RJ45 Network port, RJ45 Serial Config/Console Access port; USB A port supports a variety of Envirosense2 environmental and control modules. See Accessories>Management Hardware section for more information about these modules.  |
| SNMP Compatibility                   | LX platform interface provides remote monitoring via Java-free HTML5 web interface, telnet, SSH and SNMP management systems  |
| Network Compatibility                | 10 Mbps; 100 Mbps (Fast Ethernet)  |



**Tripp Lite**  
1111 W. 35th Street  
Chicago, IL 60609 USA  
Telephone: 773.869.1234  
www.tripplite.com

| <b>FEATURES &amp; SPECIFICATIONS</b> |   |
|--------------------------------------|---|
| High Availability PDU Features       | Remote Network Notifications  |
| <b>STANDARDS &amp; COMPLIANCE</b>    |   |
| Certifications                       | Tested to UL60950-1: 2007 R12.11 (USA), CAN/CSA-C22.2 NO. 60950-1:2007 (2nd Ed) +A1: 2011(Canada), CLASS A PART 15 (FCC/ICES Compliance), NOM (Mexico), RoHS compliant, TAA Compliant |
| Certification Details                | Series Number(s) AG-0044  |
| <b>WARRANTY</b>                      |   |
| Product Warranty Period (Worldwide)  | 2-year limited warranty   |

© 2022 Tripp Lite. All rights reserved. All product and company names are trademarks or registered trademarks of their respective holders. Use of them does not imply any affiliation with or endorsement by them. Tripp Lite has a policy of continuous improvement. Specifications are subject to change without notice. Tripp Lite uses primary and third-party agencies to test its products for compliance with standards. See a list of Tripp Lite's testing agencies: <https://www.tripplite.com/products/product-certification-agencies>