

16.2kW 3-Phase Monitored Per-Outlet PDU - LX Platform, 12 C19 & 6 C13 Outlets (208/240V), IEC 309 60A Blue, 0U, TAA

MODEL NUMBER: PDU3EVNR6G60A

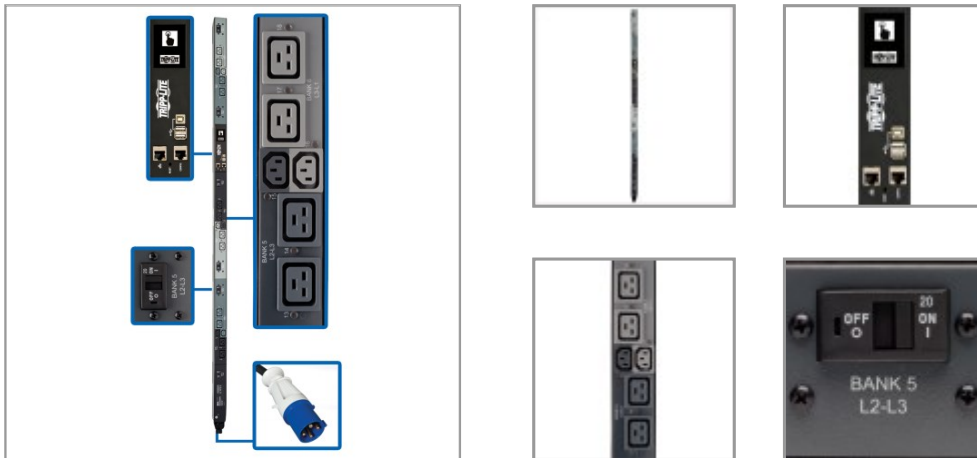

3-phase PDU allows real-time remote monitoring of individual outlets to help you track power consumption trends and detect problems early.

Features

16.2kW 3-Phase PDU Distributes and Monitors Network-Grade PowerThis monitored PDU provides real-time remote monitoring of voltage and load levels via its built-in network interface. Ideal for your data center, computer room or high-density network closet, the PDU3EVNR6G60A features 12 C19 and six C13 208/240V outlets in three breakered load banks, which distribute AC power to rack equipment. Plug-lock insert sleeves are included to prevent equipment cables from becoming accidentally dislodged.

Monitored Per-Outlet PDU Lets You Keep Track of Power Consumption in Real TimeNot only can you remotely monitor voltage and frequency, but the PDU3EVNR6G60A also allows metering of per-phase input current, as well as output current per bank and per outlet. Banks can be individually monitored to ensure proper load balance and prevent downtime. Monitoring each outlet allows you to study power consumption trends for each connected device. This helps you detect hardware problems and network traffic bottlenecks, as well as compare power usage among various devices.

Built-In LX Platform Network Management Card Allows Remote Access 24/7The Java-free HTML5-based LX Platform network interface enables full remote access for PDU status monitoring and email notifications via secure web browser, SNMP, Telnet or SSH. Full 10/100/1000 Mbps auto-sensing enables optimum communication with an Ethernet network. Optional EnviroSense2 modules (sold separately) provide a variety of environmental monitoring capabilities. Protocols supported include HTTP, HTTPS, SMTP, SNMPv1, SNMPv2, SNMPv3, FTP, DHCP and NTP.

Color Touchscreen LCD Gives You Important Data at a GlanceAn easy-to-navigate color touchscreen LCD reports network data, including IP address, input current per phase, and output current per load bank and per outlet with $\pm 1\%$ billing-grade accuracy. It also generates a unique QR code to allow read-only access to the PDU via PowerAlert® Device Manager. If an EnviroSense2 module is connected, the LCD also displays status and environmental data, including temperature and humidity.

Easy to Install Vertically in an EIA-Standard 19 in. RackThe 70-inch 0U PDU mounts vertically using the included toolless mounting buttons or the included rack-mounting brackets. Spare buttons are also included. Use the included PDUMVROTATEBRKT kit to install the PDU with outlets facing the rear for better airflow or equipment access. A six-foot cord with an IEC 309 60A Blue 208V input connects the PDU to a compatible AC power source, generator or protected UPS.

TAA-Compliant for GSA Schedule PurchasesThe PDU3EVNR6G60A is compliant with the Federal Trade Agreements Act (TAA), which makes it eligible for GSA (General Services Administration) Schedule and other federal procurement contracts.

Highlights

- Advanced remote capabilities include outlet-level current monitoring in real time
- 12 C19 and 6 C13 208/240V outlets distribute AC power to connected equipment
- Built-in Java-free HTML5-based LX Platform interface allows you 24/7 remote access
- Color touchscreen LCD provides current levels, environmental data and network info
- Installs in 0U of rack space in standard 19 in. racks using included mounting hardware

Applications

- Power mission-critical rack equipment in a data center, computer room or high-density network closet in a government, commercial or industrial facility
- Monitor power loads from various computers, switches, servers and other networking equipment
- Study power consumption trends over time for equipment connected to each individual outlet

Package Includes

- PDU3EVNR6G60A 16.2kW 3-Phase Monitored Per-Outlet PDU
- Built-in LX Platform interface
- Configuration cable
- (18) Plug-lock insert sleeves



- Rack-mounting hardware
- Spare mounting buttons
- PDUMVROTATEBRKT mounting bracket accessory
- Owner's manual

Specifications

OVERVIEW	
UPC Code	037332242242
PDU Type	Monitored
INPUT	
PDU Input Voltage	208
Recommended Electrical Service	60A 208V Dedicated Circuit with IEC 309 60A Blue compatible outlet
Maximum Input Amps	45
PDU Plug Type	(1) IEC-309 60A BLUE (3P+E)
Input Phase	3-Phase
Input Cord Length (ft.)	6
Input Cord Length (m)	1.83
OUTPUT	
Output Capacity Details	16.2kW (208V) total capacity; 26A max per output phase (L1-L2, L2-L3, L3-L1); 20A max per breaker outlet bank; 16A max per C19 outlet; 12A max per C13 outlet
Frequency Compatibility	50 / 60 Hz
Output Receptacles	(6) C13; (12) C19
Output Nominal Voltage	208
Overload Protection	6 20A circuit breakers, one per output load bank
USER INTERFACE, ALERTS & CONTROLS	
Reported Load Segments	Reports input current per phase (L1, L2, L3) and output current for each breaker outlet bank (26A combined max per banks B1+B4, B2+B5, B3+B6); 20A Max per banks B1-B6); Outlets are color-coded and labeled for phase and load bank identification; L1-L2 feeds black outlets (B1 & B4); L2-L3 feeds dark-gray outlets (B2 & B5); L3-L1 feeds light-gray outlets (B3 & B6)
Front Panel LCD Display	Touchscreen LCD reports NETWORK DATA (IP address, Subnet Mask, Gateway, MAC Address, Device Name, Model, Serial Number), INPUT PHASE DATA (Amperage, Wattage, Voltage per phase, plus Unbalance percentage), LOAD BANK DATA (Amperage, Wattage, Voltage per load bank, plus total PDU output in watts), OUTLET DATA (Amperage, Wattage per outlet), CONFIGURATION DATA (Listing of current configuration settings), ENVIRONMENTAL DATA (Reports data and status of E2 sensor modules; Sensor options are available for temperature and humidity, plus input and output dry contacts), MOBILE ACCESS (Generates a unique QR code to view reported PDU details on a mobile device)



Front Panel LEDs	One LED for each output receptacle offers power availability information: GREEN (Power ON, load bank capacity <80%), YELLOW (Power ON, load bank capacity >80%), RED (Undervoltage), RED FLASHING (Power OFF/breaker trip), LED OFF (Power OFF); Network Interface LEDs report Network Activity (Green, Flashes for network activity), Link/Network Speed (Yellow, On steady for any speed).
Switches	LX Platform Interface: Recessed reset switch for interface reboot and factory reset
Current Measurement Accuracy (Amps)	+/-1%
Voltage Measurement Accuracy (Volts)	+/-1%
Power Measurement Accuracy (Watts)	+/-1%
PHYSICAL	
Form Factors Supported	Vertical rackmount installation supported with included mounting brackets; supports toolless mounting in button-mount compatible racks
Material of Construction	Metal
PDU Form Factor	Vertical (0U)
Shipping Dimensions (hwd / in.)	6.89 x 9.65 x 75.87
Shipping Weight (kg)	12.28
Unit Dimensions (hwd / cm)	177.8 x 5.51 x 7.26
Unit Dimensions (hwd / in.)	70 x 2.17 x 2.49
Unit Weight (kg)	6.41
Unit Weight (lbs.)	14.13
ENVIRONMENTAL	
Operating Temperature Range	32 to 122F (0 to 50C)
Storage Temperature Range	-30°C to +60°C (-22°F to +140°F)
Relative Humidity	5 to 95% non-condensing
Operating Elevation (ft.)	0-10,000
Operating Elevation (m)	0-3000m
COMMUNICATIONS	
PowerAlert Software	LX Platform Interface: PowerAlert Device Manager15 (PADM15)
Communications Cable	USB B-to-USB A Configuration/Console Access cable
Network Monitoring Port	RJ45 Network port, RJ45 Config/Console Access port; 2x USB A ports supports a variety of Envirosense2 environmental and control modules. See Accessories>Management Hardware section for more information about these modules. USB B port (Configuration & Console Access)
SNMP Compatibility	SNMP V1, V2c, V3
Network Speed	10/100 Mbps; 1Gbps
Communications Interface	Pre-installed network card; RS-232; USB
SPECIAL FEATURES	



Tripp Lite
1111 W. 35th Street
Chicago, IL 60609 USA
Telephone: 773.869.1234
www.tripplite.com

High Availability PDU Features	Auto Probe Monitoring (included)
STANDARDS & COMPLIANCE	
Certifications	Tested to UL60950-1:2007 R10.14 (USA), CAN/CSA-C22.2 NO. 60650-1:2007 (Canada), Class A Part 15 (Emissions), NOM (Mexico), RoHS compliant, TAA Compliant
WARRANTY	
Product Warranty Period (Worldwide)	2-year limited warranty

© 2020 Tripp Lite. All rights reserved. All product and company names are trademarks or registered trademarks of their respective holders. Use of them does not imply any affiliation with or endorsement by them. Tripp Lite has a policy of continuous improvement. Specifications are subject to change without notice. Tripp Lite uses primary and third-party agencies to test its products for compliance with standards. See a list of Tripp Lite's testing agencies: <https://www.tripplite.com/products/product-certification-agencies>